

REDUCING PORT CONNECTOR

TRPC

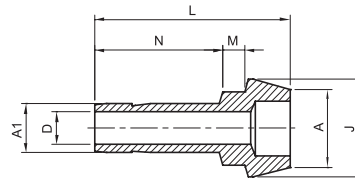

CONNECTS TWO T-LOK PORTS (METRIC)													
Part Number	A Tube O.D.		A1 Tube O.D.	D		N		L		J		M	
	mm	mm	mm	mm	mm	mm	mm	mm	mm	mm	mm	mm	mm
TRPC - 6M - 3M	6	3	2.1	13.5	22.9	9.0	3.2						
TRPC - 8M - 6M	8	6	4.0	15.7	24.7	11.0	3.1						
TRPC - 10M - 6M	10	6	4.0	15.7	25.8	13.1	3.4						
TRPC - 10M - 8M	10	8	5.6	16.8	26.1	13.1	3.1						
TRPC - 12M - 6M	12	6	4.0	15.7	29.1	15.0	3.6						
TRPC - 12M - 8M	12	8	5.6	16.8	30.1	15.0	3.4						
TRPC - 12M - 10M	12	10	7.1	17.5	30.6	15.0	3.1						
TRPC - 16M - 10M	16	10	8.8	23.1	37.5	19.0	3.4						

CONNECTS TWO T-LOK PORTS (INCH)														
Part Number	A Tube O.D.		A1 Tube O.D.		D		N		L		J		M	
	in	mm	in	mm	in	mm	in	mm	in	mm	in	mm	in	mm
TRPC - 2 - 1	1/8	3.17	1/16	1.58	0.03	0.75	0.36	9.14	0.72	18.3	0.24	6.15	0.10	2.56
TRPC - 4 - 1	1/4	6.35	1/16	1.58	0.03	0.75	0.36	9.14	0.75	19.05	0.37	9.40	0.15	3.81
TRPC - 4 - 2	1/4	6.35	1/8	3.17	0.09	2.20	0.54	13.71	0.90	22.86	0.37	9.40	0.12	3.05
TRPC - 6 - 2	3/8	9.52	1/8	3.17	0.09	2.20	0.54	13.71	0.92	23.37	0.50	12.7	0.15	3.76
TRPC - 6 - 4	3/8	9.52	1/4	6.35	0.17	4.20	0.64	16.26	1.00	25.4	0.50	12.7	0.13	3.24
TRPC - 8 - 4	1/2	12.70	1/4	6.35	0.17	4.20	0.64	16.26	1.17	29.72	0.62	15.8	0.14	3.66
TRPC - 8 - 6	1/2	12.70	3/8	9.52	0.27	6.85	0.70	17.78	1.21	30.73	0.62	15.8	0.12	3.15
TRPC - 12 - 8	3/4	19.05	1/2	12.70	0.37	9.40	0.96	24.38	1.49	37.85	0.87	22.1	0.15	3.87

Reducing port connector TRPC

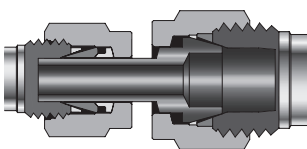

"D" - Dimension is minimum opening - dimensions are for reference only, and are subject to change without notice.