

MALE TUBE ADAPTER

TMTA

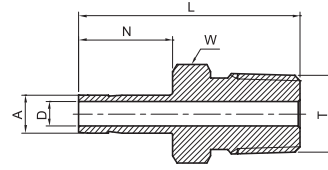

TUBE (METRIC) MALE PIPE NPT THREAD

Part Number	A Tube O.D.	T NPT	D	W Hex. flat	N	L
	mm	in	mm	mm	mm	mm
TMTA - 3M - 2N	3	1/8	2.1	12	13.5	30.0
TMTA - 3M - 4N	3	1/4	2.1	14	13.5	35.3
TMTA - 6M - 2N	6	1/8	4.0	12	15.7	32.8
TMTA - 6M - 4N	6	1/4	4.0	14	15.7	38.1
TMTA - 6M - 6N	6	3/8	4.0	14	15.7	37.0
TMTA - 6M - 8N	6	1/2	4.0	22	15.7	43.4
TMTA - 8M - 2N	8	1/8	5.6	12	16.9	33.5
TMTA - 8M - 4N	8	1/4	5.6	14	16.9	39.1
TMTA - 8M - 8N	8	1/2	5.6	22	16.9	43.0
TMTA - 10M - 4N	10	1/4	7.1	14	17.6	39.9
TMTA - 10M - 6N	10	3/8	7.7	18	17.6	40.6
TMTA - 10M - 8N	10	1/2	7.7	22	17.6	46.2
TMTA - 12M - 4N	12	1/4	7.1	16	23.3	46.5
TMTA - 12M - 6N	12	3/8	9.1	18	23.3	46.5
TMTA - 12M - 8N	12	1/2	9.1	22	23.3	52.0
TMTA - 16M - 8N	16	1/2	11.9	22	24.7	50.5
TMTA - 20M - 12N	20	3/4	15.1	27	26.6	54.3

"D" - Dimension is minimum opening - dimensions are for reference only, and are subject to change without notice.

MALE TUBE ADAPTER

TMTA

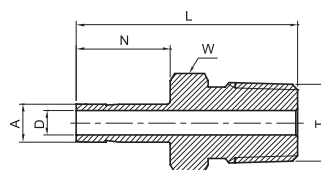

TUBE (INCH) MALE PIPE NPT THREAD											
Part Number	A Tube O.D.		T NPT	D		W Hex. flat		N		L	
	in	mm		in	in	mm	in	mm	in	mm	in
TMTA - 2 - 2N	1/8	3.17	1/8	0.09	2.3	7/16	11.1	0.53	13.5	1.16	29.5
TMTA - 2 - 4N	1/8	3.17	1/4	0.09	2.2	9/16	14.3	0.53	13.5	1.37	34.8
TMTA - 3 - 2N	3/16	4.76	1/8	0.12	3.0	7/16	11.1	0.56	14.2	1.19	30.2
TMTA - 3 - 4N	3/16	4.76	1/4	0.12	3.0	9/16	14.3	0.56	14.2	1.40	35.6
TMTA - 4 - 2N	1/4	6.35	1/8	0.17	4.2	7/16	11.1	0.62	15.7	1.25	31.8
TMTA - 4 - 4N	1/4	6.35	1/4	0.17	4.2	9/16	14.3	0.62	15.7	1.46	37.1
TMTA - 4 - 6N	1/4	6.35	3/8	0.17	4.2	11/16	17.5	0.62	15.7	1.49	37.9
TMTA - 4 - 8N	1/4	6.35	1/2	0.17	4.2	7/8	22.2	0.62	15.7	1.71	43.4
TMTA - 5 - 2N	5/16	7.93	1/8	0.24	6.0	7/16	11.1	0.67	16.9	1.29	32.7
TMTA - 5 - 4N	5/16	7.93	1/4	0.24	6.0	9/16	14.3	0.67	16.9	1.50	38.1
TMTA - 6 - 2N	3/8	9.52	1/8	0.28	7.1	7/16	11.1	0.69	17.5	1.32	33.5
TMTA - 6 - 4N	3/8	9.52	1/4	0.28	7.1	9/16	14.3	0.69	17.5	1.53	38.9
TMTA - 6 - 6N	3/8	9.52	3/8	0.28	7.1	11/16	17.5	0.69	17.5	1.56	39.6
TMTA - 6 - 8N	3/8	9.52	1/2	0.28	7.1	7/8	22.2	0.69	17.5	1.78	45.2
TMTA - 8 - 4N	1/2	12.70	1/4	0.28	7.1	9/16	14.3	0.92	23.3	1.75	44.5
TMTA - 8 - 6N	1/2	12.70	3/8	0.39	9.9	11/16	17.5	0.92	23.3	1.78	45.2
TMTA - 8 - 8N	1/2	12.70	1/2	0.39	9.9	7/8	22.2	0.92	23.3	20.0	50.8
TMTA - 10 - 6N	5/8	15.87	3/8	0.39	9.9	11/16	17.5	0.97	24.7	1.81	47.6
TMTA - 10 - 8N	5/8	15.87	1/2	0.47	11.9	7/8	22.2	0.97	24.7	2.06	52.3
TMTA - 10 - 12N	5/8	15.87	3/4	0.50	12.7	1-1/16	27.0	0.97	24.7	2.06	52.3
TMTA - 12 - 8N	3/4	19.05	1/2	0.47	11.9	7/8	22.2	0.97	24.7	2.06	52.3
TMTA - 12 - 12N	3/4	19.05	3/4	0.59	15.0	1-1/16	27.0	0.97	24.7	2.06	52.3
TMTA - 12 - 16N	3/4	19.05	1	0.59	15.0	1-3/8	34.9	0.97	24.7	2.28	57.3
TMTA - 14 - 12N	7/8	22.22	3/4	0.60	15.9	1-1/16	27.0	1.05	26.6	2.09	54.3
TMTA - 16 - 12N	1	25.40	3/4	0.60	15.8	1-1/16	27.0	1.30	33.0	2.31	58.7
TMTA - 16 - 16N	1	25.4	1	0.8	20.3	1-3/8	34.9	1.3	33.0	2.6	66.0
TMTA - 20 - 20N	1-1/4	31.75	1-1/4	1.02	25.9	1-3/4	44.5	1.72	43.9	3.16	80.3
TMTA - 24 - 24N	1-1/2	38.1	1-1/2	1.25	31.8	2-1/8	54.0	2.06	52.5	3.72	94.5
TMTA - 32 - 32N	2	50.8	2	1.72	43.7	2-9/16	65.1	2.73	69.4	3.72	119.4

"D" - Dimension is minimum opening - dimensions are for reference only, and are subject to change without notice.

MALE TUBE ADAPTER

TMTA

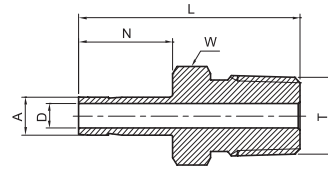

TUBE (INCH) MALE PIPE ISO TAPERED THREAD

Part Number	A Tube O.D.		T ISO	D		W Hex. flat		N		L	
	in	mm		in	mm	in	mm	in	mm	in	mm
TMTA - 2 - 2P	1/8	3.17	R 1/8	0.09	2.3	7/16	11.1	0.53	13.5	1.16	29.5
TMTA - 2 - 4P	1/8	3.17	R 1/4	0.09	2.2	9/16	14.3	0.53	13.5	1.37	34.8
TMTA - 3 - 2P	3/16	4.76	R 1/8	0.12	3.0	7/16	11.1	0.56	14.2	1.19	30.2
TMTA - 3 - 4P	3/16	4.76	R 1/4	0.12	3.0	9/16	14.3	0.56	14.2	1.40	35.6
TMTA - 4 - 2P	1/4	6.35	R 1/8	0.17	4.2	7/16	11.1	0.62	15.7	1.25	31.8
TMTA - 4 - 4P	1/4	6.35	R 1/4	0.17	4.2	9/16	14.3	0.62	15.7	1.46	37.1
TMTA - 4 - 6P	1/4	6.35	R 3/8	0.17	4.2	11/16	17.5	0.62	15.7	1.49	37.9
TMTA - 4 - 8P	1/4	6.35	R 1/2	0.17	4.2	7/8	22.2	0.62	15.7	1.71	43.4
TMTA - 5 - 2P	5/16	7.93	R 1/8	0.24	6.0	7/16	11.1	0.67	16.9	1.29	32.7
TMTA - 5 - 4P	5/16	7.93	R 1/4	0.24	6.0	9/16	14.3	0.67	16.9	1.50	38.1
TMTA - 6 - 2P	3/8	9.52	R 1/8	0.28	7.1	7/16	11.1	0.69	17.5	1.32	33.5
TMTA - 6 - 4P	3/8	9.52	R 1/4	0.28	7.1	9/16	14.3	0.69	17.5	1.53	38.9
TMTA - 6 - 6P	3/8	9.52	R 3/8	0.28	7.1	11/16	17.5	0.69	17.5	1.56	39.6
TMTA - 6 - 8P	3/8	9.52	R 1/2	0.28	7.1	7/8	22.2	0.69	17.5	1.78	45.2
TMTA - 8 - 4P	1/2	12.70	R 1/4	0.28	7.1	9/16	14.3	0.92	23.3	1.75	44.5
TMTA - 8 - 6P	1/2	12.70	R 3/8	0.39	9.9	11/16	17.5	0.92	23.3	1.78	45.2
TMTA - 8 - 8P	1/2	12.70	R 1/2	0.39	9.9	7/8	22.2	0.92	23.3	2.00	50.8
TMTA - 10 - 6P	5/8	15.87	R 3/8	0.39	9.9	11/16	17.5	0.97	24.7	1.81	47.6
TMTA - 10 - 8P	5/8	15.87	R 1/2	0.47	11.9	7/8	22.2	0.97	24.7	2.06	52.3
TMTA - 10 - 12P	5/8	15.87	R 3/4	0.50	12.7	1-1/16	27.0	0.97	24.7	2.06	52.3
TMTA - 12 - 8P	3/4	19.05	R 1/2	0.47	11.9	7/8	22.2	0.97	24.7	2.06	52.3
TMTA - 12 - 12P	3/4	19.05	R 3/4	0.59	15.0	1-1/16	27.0	0.97	24.7	2.06	52.3
TMTA - 12 - 16P	3/4	19.05	R 1	0.59	15.0	1-3/8	34.9	0.97	24.7	2.28	57.3
TMTA - 14 - 12P	7/8	22.22	R 3/4	0.60	15.9	1-1/16	27.0	1.05	26.6	2.09	54.3
TMTA - 16 - 16P	1	25.4	R 1	0.8	20.3	1-3/8	34.9	1.3	33.0	2.6	66.0
TMTA - 20 - 20P	1-1/4	31.75	R 1-1/4	1.02	25.9	1-3/4	44.5	1.72	43.9	3.16	80.3
TMTA - 24 - 24P	1-1/2	38.1	R 1-1/2	1.25	31.8	2-1/8	54.0	2.06	52.5	3.72	94.5
TMTA - 32 - 32P	2	50.8	R 2	1.72	43.7	2-9/16	65.1	2.73	69.4	3.72	119.4

"D" - Dimension is minimum opening - dimensions are for reference only, and are subject to change without notice.